

SR31 Sealed Rivet

Dome head · Steel body · Steel stem · Sealed
3.2 mm (1/8") - 4.8 mm (3/16")

Features

- Fully sealed and weather proof, sealed against moisture air and other contaminants
- Good hole fill and retained stem provide strong vibration resistant joints
- Higher tensile and shear strength than equivalent open end rivets

Material

- Body: Steel, zinc plated
- Stem: Steel, zinc plated

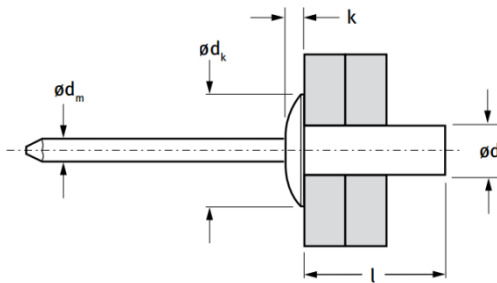

Before Placement

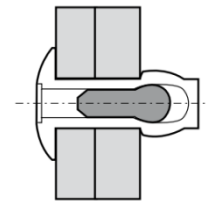

After Placement

Part No.	Size ø	Grip Range		Hole Size	ød	l	ød _k	k	ød _m	Shear (typical) kN	Tension (typical) kN
		min.	max.								
OSR31-03260	3.2 (1/8")	0.5	1.5	3.3	3.2	6.0	6.0 [±0.24]	1.0	1.9	1.6	2.2
OSR31-03280		1.5	3.0			8.0					
OSR31-03295		3.0	5.0			9.5					
OSR31-03212		5.0	7.0			12.0					
OSR31-04060	4.0 (5/32")	0.5	1.5	4.1	4.0	6.0	8.0 [±0.29]	1.4	2.3	2.3	2.5
OSR31-04080		1.5	3.0			8.0					
OSR31-04010		3.0	5.0			10.0					
OSR31-04012		5.0	6.5			12.0					
OSR31-04015		6.5	10.5			15.0					
OSR31-04880	4.8 (3/16")	1.0	3.0	4.9	4.8	8.0	9.5 [±0.29]	1.7	2.9	2.9	3.8
OSR31-04810		3.0	5.0			9.5					
OSR31-04812		5.0	6.5			12.0					
OSR31-04816		6.5	10.5			16.0					